

STRATEGOS III

Wheelchair lift B

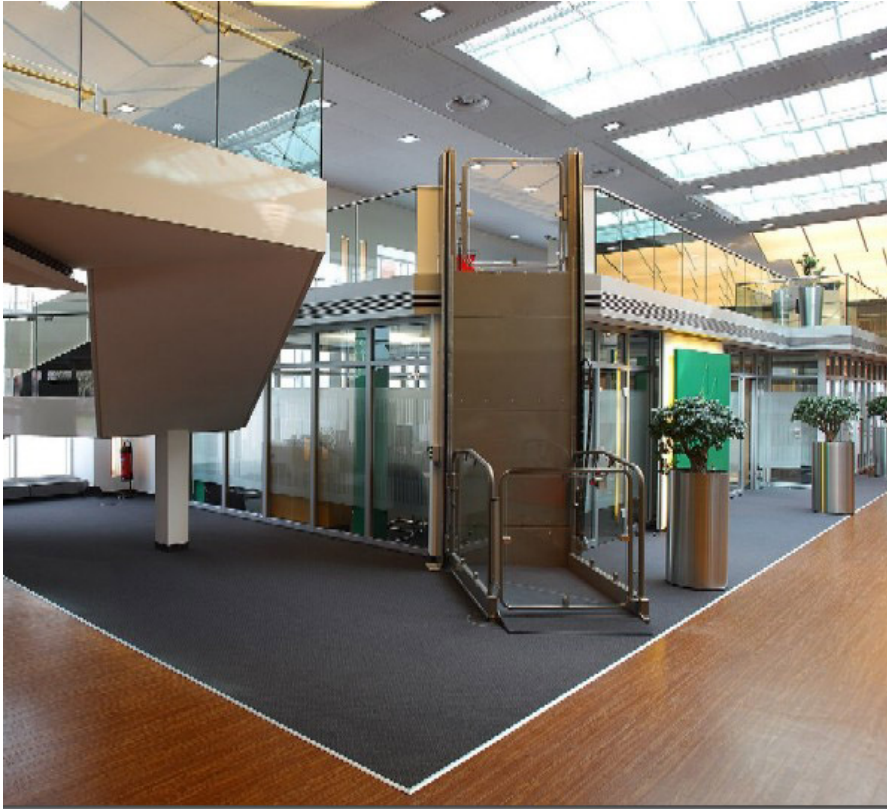

- STRATEGOS is hot galvanized as standard (Any RAL colour powder coating as option)
- Stainlesssteel, optional
- Safe and reliable
- Made for out door as well as for indoor use
- No pit required
- CE-marked, type certified by Inspecta fullfills SS-2097-7
- Simple attachment against a wall - ceiling the lifting device needs a steady ground
- Can be mounted on a free standing frame
- Safety plate under the platform
- Emergency lowering by a crank or UPS
- Side panels and doors have polycarbonate a safety protection

Technical description:

- Single phase, 1 x 230V, 16A
- Rated load: 300kg or 2 persons
- Lifting height: 0,5 – 3,0m
- Speed: 0,08 m/s
- Motor: 2,5Kw, beltdrive, double screw and nut
- Electrical connection: 3 x 2,5 mm²
- Manouever: 24 Volt
- Soft start / stop with frequency inverter



Option:

- Powder coating
- Different flooring
- Side access
- Powered doors
- Powered ramp
- Safety glas



ASCENSION LIFTS



CE
Made in Sweden

MPR Lifts AB

Ävägen 4, S-232 91 ARLÖV, SWEDEN
TEL. 040-43 70 75 FAX. 040-43 29 44
Mail: info@mprlift.nu
Homepage www.mprlift.nu